

APN

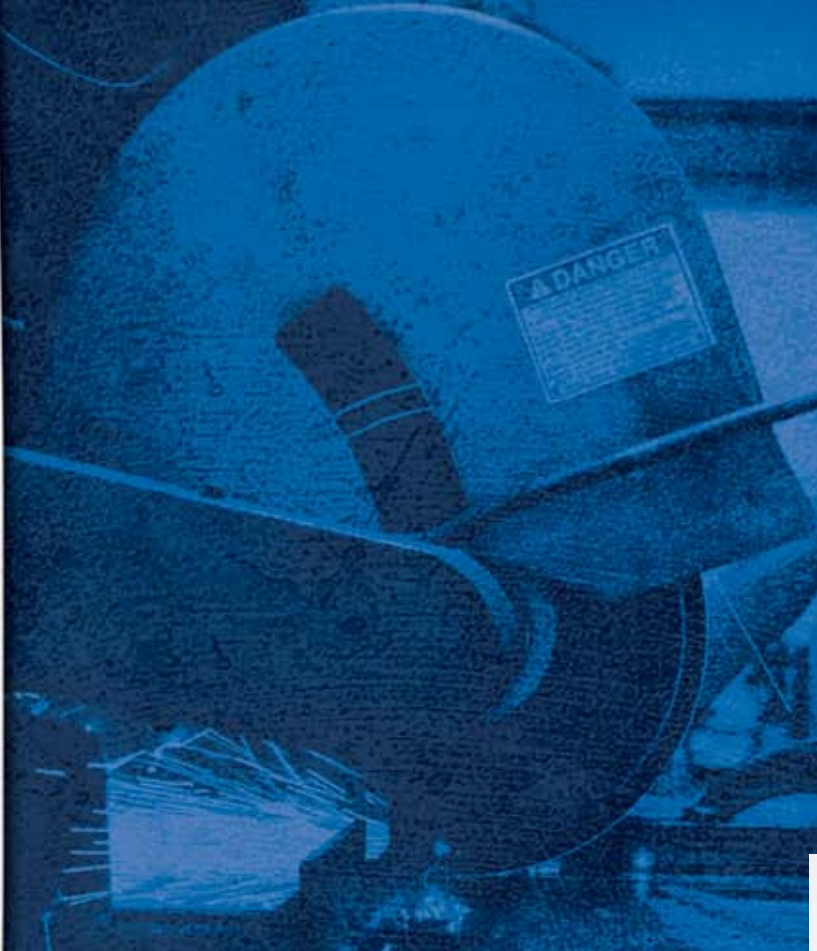





Where precision and value take form



STANDARD AND CUSTOM STAINLESS STEEL TUBE FITTINGS



TUBE O.D. FITTINGS

CONTENTS		Bevel Seat Fittings
		BPE Fittings
		Clamp Fittings
		I-Line Fittings
		John Perry Fittings
		Sanitary Butt weld Fittings
		Tube O.D. Fittings

Call toll-free to order: 877.276.7766 • www.apn-inc.net

2WCL

90° Buttweild Elbow

304 Item Number	Tube O.D.	A	Nominal Wall Thickness	316L Item Number
2WCL-0050-1-4	.50	.75	0.065	2WCL-0050-1-6
2WCL-0075-1-4	.75	1.125	0.065	2WCL-0075-1-6
2WCL-0100-1-4	1	1.50	0.065	2WCL-0100-1-6
2WCL-0125-1-4	1.25	1.875	0.065	2WCL-0125-1-6
2WCL-0150-1-4	1.50	2.25	0.065	2WCL-0150-1-6
2WCL-0200-1-4	2	3.00	0.065	2WCL-0200-1-6
2WCL-0250-1-4	2.50	3.75	0.065	2WCL-0250-1-6
2WCL-0300-1-4	3	4.50	0.065	2WCL-0300-1-6
2WCL-0400-1-4	4	6.00	0.083	2WCL-0400-1-6
2WCL-0600-1-4	6	9.00	0.109	2WCL-0600-1-6

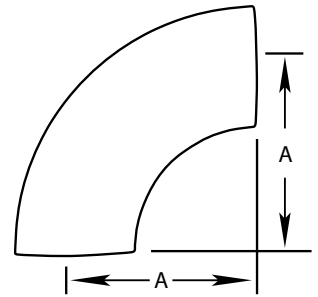

2S

90° Buttweild Elbow with Tangents

304 Item Number	Tube O.D.	A	Nominal Wall Thickness	316L Item Number
—	.75	1.42	0.065	2S-0075-1-6
2S-0100-1-4	1	2.062	0.065	2S-0100-1-6
2S-0150-1-4	1.50	2.937	0.065	2S-0150-1-6
2S-0200-1-4	2	4.062	0.065	2S-0200-1-6
2S-0250-1-4	2.50	5.187	0.065	2S-0250-1-6
2S-0300-1-4	3	6.312	0.065	2S-0300-1-6
2S-0400-1-4	4	8.312	0.083	2S-0400-1-6

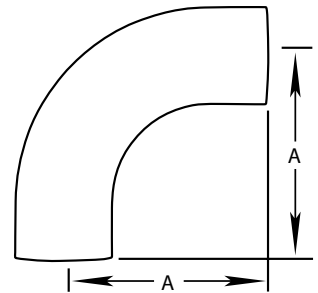

2WK

45° Buttweild Elbow

304 Item Number	Tube O.D.	A	Nominal Wall Thickness	316L Item Number
2WK-0100-1-4	1	0.625	0.065	2WK-0100-1-6
2WK-0125-1-4	1.25	0.781	0.065	2WK-0125-1-6
2WK-0150-1-4	1.50	0.937	0.065	2WK-0150-1-6
2WK-0200-1-4	2	1.250	0.065	2WK-0200-1-6
2WK-0250-1-4	2.50	1.562	0.065	2WK-0250-1-6
2WK-0300-1-4	3	1.875	0.065	2WK-0300-1-6
2WK-0400-1-4	4	2.500	0.083	2WK-0400-1-6
2WK-0600-1-4	6	3.750	0.109	2WK-0600-1-6

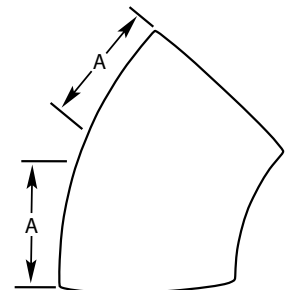

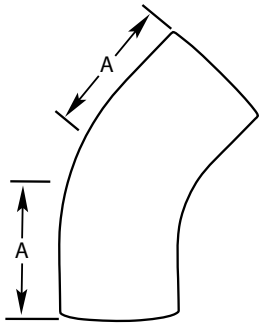

2KS

45° Butt Weld Elbow with Tangents

304 Item Number	Tube O.D.	A	Nominal Wall Thickness	316L Item Number
2KS-0100-1-4	1	1.188	0.065	2KS-0100-1-6
2KS-0150-1-4	1.50	1.625	0.065	2KS-0150-1-6
2KS-0200-1-4	2	2.312	0.065	2KS-0200-1-6
2KS-0250-1-4	2.50	3.000	0.065	2KS-0250-1-6
2KS-0300-1-4	3	3.688	0.065	2KS-0300-1-6
2KS-0400-1-4	4	4.812	0.083	2KS-0400-1-6

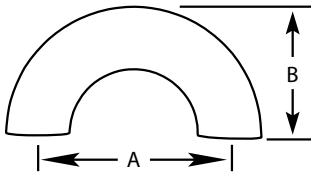

2WUL

180° Butt Weld Return Bend

304 Item Number	Tube O.D.	A	B	Nominal Wall Thickness	316L Item Number
-	.75	2.25	1.50	N/A	2WUL-0075-1-6
2WUL-0100-1-4	1	3.0	2.0	0.065	2WUL-0100-1-6
2WUL-0125-1-4	1.25	3.75	2.50	N/A	2WUL-0125-1-6
2WUL-0150-1-4	1.50	4.5	3.0	0.065	2WUL-0150-1-6
2WUL-0200-1-4	2	6.0	4.0	0.065	2WUL-0200-1-6
2WUL-0250-1-4	2.50	7.5	5.0	0.065	2WUL-0250-1-6
2WUL-0300-1-4	3	9.0	6.0	0.065	2WUL-0300-1-6
2WUL-0400-1-4	4	12.0	8.0	0.083	2WUL-0400-1-6

7WWW

Butt Weld Short Tee

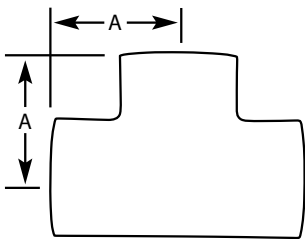

304 Item Number	Tube O.D.	A	Nominal Wall Thickness	316L Item Number
7WWW-0100-1-4	1	1.125	0.065	7WWW-0100-1-6
7WWW-0150-1-4	1.5	1.656	0.065	7WWW-0150-1-6
7WWW-0200-1-4	2	2.062	0.065	7WWW-0200-1-6
7WWW-0250-1-4	2.5	2.344	0.065	7WWW-0250-1-6
7WWW-0300-1-4	3	2.594	0.065	7WWW-0300-1-6
7WWW-0400-1-4	4	3.438	0.083	7WWW-0400-1-6

7W

Buttweld Long Tee

304 Item Number	Tube O.D.	A	B	Nominal Wall Thickness	316L Item Number
7W-0050-1-4	.50	2.125	4.250	0.065	7W-0050-1-6
7W-0075-1-4	.75	2.125	4.250	0.065	7W-0075-1-6
7W-0100-1-4	1	1.875	3.75	0.065	7W-0100-1-6
7W-0125-1-4	1.25	2.25	4.50	0.065	7W-0125-1-6
7W-0150-1-4	1.50	2.250	4.50	0.065	7W-0150-1-6
7W-0200-1-4	2	3.000	6.00	0.065	7W-0200-1-6
7W-0250-1-4	2.50	3.000	6.00	0.065	7W-0250-1-6
7W-0300-1-4	3	3.250	6.50	0.065	7W-0300-1-6
7W-0400-1-4	4	3.875	7.75	0.083	7W-0400-1-6
7W-0600-1-4	6	5.625	11.25	0.109	7W-0600-1-6

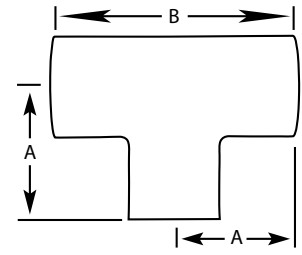

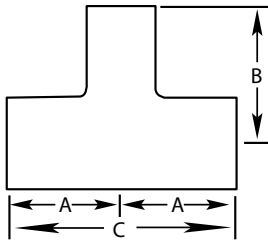

7WR

Buttweld Long Reducing Tee

304 Item Number	Tube O.D.	A	B	Nominal Wall Thickness	C	316L Item Number
7WR-0150X0100-1-4	1.5 x 1	2.250	2.125	0.065	4.50	7WR-0150X0100-1-6
7WR-0200X0100-1-4	2 x 1	3.000	2.375	0.065	6.00	7WR-0200X0100-1-6
7WR-0200X0150-1-4	2 x 1.5	3.000	2.500	0.065	6.00	7WR-0200X0150-1-6
7WR-0250X0150-1-4	2.5 x 1.5	3.000	2.750	0.065	6.00	7WR-0250X0150-1-6
7WR-0250X0200-1-4	2.5 x 2	3.000	3.250	0.065	6.00	7WR-0250X0200-1-6
7WR-0300X0150-1-4	3 x 1.5	3.250	3.000	0.065	6.50	7WR-0300X0150-1-6
7WR-0300X0200-1-4	3 x 2	3.250	3.500	0.065	6.50	7WR-0300X0200-1-6
7WR-0300X0250-1-4	3 x 2.5	3.250	3.250	0.065	6.50	7WR-0300X0250-1-6
7WR-0400X0200-1-4	4 x 2	3.875	4.000	0.083	7.75	7WR-0400X0200-1-6
7WR-0400X0250-1-4	4 x 2.5	3.875	3.750	0.083	7.75	7WR-0400X0250-1-6
7WR-0400X0300-1-4	4 x 3	3.875	3.750	0.083	7.75	7WR-0400X0300-1-6
7WR-0600X0200-1-4	6 x 2	5.625	5.625	0.109	11.25	7WR-0600X0200-1-6
7WR-0600X0300-1-4	6 x 3	5.625	5.625	0.109	11.25	7WR-0600X0300-1-6
7WR-0600X0400-1-4	6 x 4	5.625	5.625	0.109	11.25	7WR-0600X0400-1-6

7RWWW

Buttweld Reducing Tee

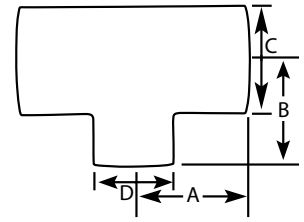

304 Item Number	Tube O.D.	A	B	C	D	Wall Thickness	316L Item Number
7RWWW-0150X0100-1-4	1.5 x 1	1.656	1.375	1.5	1.00	0.065	7RWWW-0150X0100-1-6
7RWWW-0200X0100-1-4	2 x 1	2.062	1.625	2.0	1.00	0.065	7RWWW-0200X0100-1-6
7RWWW-0200X0150-1-4	2 x 1.5	2.062	1.906	2.0	1.50	0.065	7RWWW-0200X0150-1-6
7RWWW-0250X0150-1-4	2.5 x 1.5	2.344	2.156	2.5	1.50	0.065	7RWWW-0250X0150-1-6
7RWWW-0250X0200-1-4	2.5 x 2	2.344	2.156	2.5	2.00	0.065	7RWWW-0250X0200-1-6
7RWWW-0300X0150-1-4	3 x 1.5	2.594	2.406	3.0	1.50	0.065	7RWWW-0300X0150-1-6
7RWWW-0300X0200-1-4	3 x 2	2.594	2.562	3.0	2.00	0.065	7RWWW-0300X0200-1-6
7RWWW-0300X0250-1-4	3 x 2.5	2.594	2.594	3.0	2.50	0.065	7RWWW-0300X0250-1-6
7RWWW-0400X0150-1-4	4 x 1.5	3.438	2.906	4.0	1.50	0.083	7RWWW-0400X0150-1-6
7RWWW-0400X0200-1-4	4 x 2	3.438	3.062	4.0	2.00	0.083	7RWWW-0400X0200-1-6
7RWWW-0400X0250-1-4	4 x 2.5	3.438	3.094	4.0	2.50	0.083	7RWWW-0400X0250-1-6
7RWWW-0400X0300-1-4	4 x 3	3.438	3.094	4.0	3.00	0.083	7RWWW-0400X0300-1-6
7RWWW-0600X0300-1-4	6 x 3	5.625	4.875	6.0	3.00	0.109	7RWWW-0600X0300-1-6
7RWWW-0600X0400-1-4	6 x 4	5.625	5.125	6.0	4.00	0.109	7RWWW-0600X0400-1-6

9W

Buttweld Long Cross

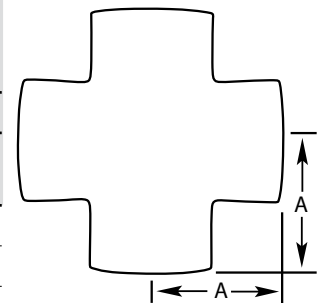

304 Item Number	Tube O.D.	A	Nominal Wall Thickness	316L Item Number
9W-0100-1-4	1	1.875	0.065	9W-0100-1-6
9W-0150-1-4	1.5	2.250	0.065	9W-0150-1-6
9W-0200-1-4	2	3.000	0.065	9W-0200-1-6
9W-0250-1-4	2.5	3.000	0.065	9W-0250-1-6
9W-0300-1-4	3	3.250	0.065	9W-0300-1-6
9W-0400-1-4	4	3.875	0.083	9W-0400-1-6
9W-0600-1-4	6	5.625	0.109	9W-0600-1-6

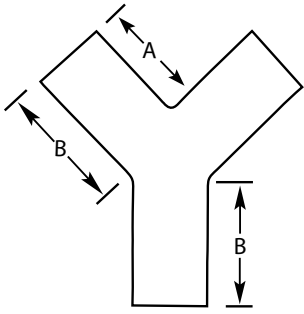

28W

Butt Weld True "Y"

304 Item Number	Tube O.D.	A	B	Nominal Wall Thickness	316L Item Number
28W-0100-1-4	1	2.000	2.438	0.065	28W-0100-1-6
28W-0150-1-4	1.5	2.000	2.438	0.065	28W-0150-1-6
28W-0200-1-4	2	2.625	3.250	0.065	28W-0200-1-6
28W-0250-1-4	2.5	3.370	4.125	0.065	28W-0250-1-6
28W-0300-1-4	3	4.000	4.875	0.065	28W-0300-1-6
28W-0400-1-4	4	5.375	5.375	0.083	28W-0400-1-6

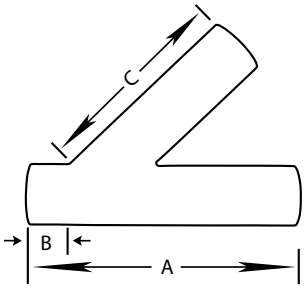

28WA

Butt Weld Lateral "Y"

304 Item Number	Tube O.D.	A	B	C	Nominal Wall Thickness	316L Item Number
28WA-0100-1-4	1	6.000	1.000	5.000	0.065	28WA-0100-1-6
28WA-0150-1-4	1.5	7.375	1.188	6.188	0.065	28WA-0150-1-6
28WA-0200-1-4	2	8.750	1.625	7.125	0.065	28WA-0200-1-6
28WA-0250-1-4	2.5	10.000	1.500	8.500	0.065	28WA-0250-1-6
28WA-0300-1-4	3	10.750	1.875	8.875	0.065	28WA-0300-1-6
28WA-0400-1-4	4	12.812	2.062	10.750	0.083	28WA-0400-1-6



16W

Butt Weld Tube Cap

304 Item Number	Tube O.D.	A	316L Item Number
-	.50	0.250	16W-0050-6
-	.75	0.312	16W-0075-6
16W-0100-4	1	0.375	16W-0100-6
16W-0125-4	1.25	0.500	16W-0125-6
16W-0150-4	1.50	0.562	16W-0150-6
16W-0200-4	2	0.750	16W-0200-6
16W-0250-4	2.50	1.000	16W-0250-6
16W-0300-4	3	1.250	16W-0300-6
16W-0400-4	4	1.500	16W-0400-6
16W-0600-4	6	2.250	16W-0600-6

19WB

Buttweld x Male NPT Adapter

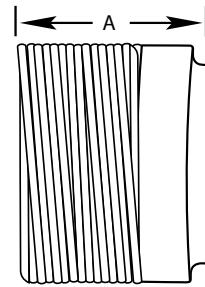

304 Item Number	Tube O.D.	A	Nominal Wall Thickness	316L Item Number
19WB-0050-4	.50	1.625	N/A	19WB-0050-6
19WB-0075-4	.75	1.625	N/A	19WB-0075-6
19WB-0100-4	1	1.750	0.065	19WB-0100-6
19WB-0125-4	1.25	1.750	N/A	19WB-0125-6
19WB-0150-4	1.50	1.750	0.065	19WB-0150-6
19WB-0200-4	2	1.812	0.065	19WB-0200-6
19WB-0250-4	2.50	2.312	0.065	19WB-0250-6
19WB-0300-4	3	2.500	0.065	19WB-0300-6
19WB-0400-4	4	2.562	0.083	19WB-0400-6
19WB-0600-4	6	4.00	0.109	19WB-0600-6

22WB

Buttweld x Female NPT Adapter

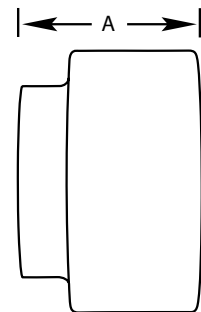

304 Item Number	Tube O.D.	A	Nominal Wall Thickness	316L Item Number
-	.50	1.125	0.065	22WB-0050-6
-	.75	1.125	0.065	22WB-0075-6
22WB-0100-4	1	1.750	0.065	22WB-0100-6
22WB-0125-4	1.25	1.375	0.065	22WB-0125-6
22WB-0150-4	1.50	1.750	0.065	22WB-0150-6
22WB-0200-4	2	1.750	0.065	22WB-0200-6
22WB-0250-4	2.50	2.250	0.065	22WB-0250-6
22WB-0300-4	3	2.500	0.065	22WB-0300-6
22WB-0400-4	4	2.625	0.083	22WB-0400-6

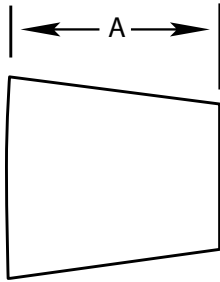

31W

Buttweld Concentric Reducer

304 Item Number	Tube O.D.	A	Nominal Wall Thickness	316L Item Number
31W-0075X0050-1-4	.75 x.5	1.0	0.065	31W-0075X0050-1-6
31W-0100X0050-1-4	1 x.5	2.0	0.065	31W-0100X0050-1-6
31W-0100X0075-1-4	1 x.75	1.0	0.065	31W-0100X0075-1-6
31W-0150X0050-1-4	1.5 x.5	4.0	0.065	31W-0150X0050-1-6
31W-0150X0075-1-4	1.5 x.75	3.0	0.065	31W-0150X0075-1-6
31W-0150X0100-1-4	1.5 x 1	2.0	0.065	31W-0150X0100-1-6
31W-0150X0125-1-4	1.5 x 1.25	1.0	0.065	31W-0150X0125-1-6
31W-0200X0050-1-4	2 x.5	6.0	0.065	31W-0200X0050-1-6
31W-0200X0075-1-4	2 x.75	5.0	0.065	31W-0200X0075-1-6
31W-0200X0100-1-4	2 x 1	4.0	0.065	31W-0200X0100-1-6
31W-0200X0125-1-4	2 x 1.25	3.0	0.065	31W-0200X0125-1-6
31W-0200X0150-1-4	2 x 1.5	2.0	0.065	31W-0200X0150-1-6
31W-0250X0150-1-4	2.5 x 1.5	4.0	0.065	31W-0250X0150-1-6
31W-0250X0200-1-4	2.5 x 2	2.0	0.065	31W-0250X0200-1-6
31W-0300X0100-1-4	3 x 1	8.0	0.065	31W-0300X0100-1-6
31W-0300X0150-1-4	3 x 1.5	6.0	0.065	31W-0300X0150-1-6
31W-0300X0200-1-4	3 x 2	4.0	0.065	31W-0300X0200-1-6
31W-0300X0250-1-4	3 x 2.5	2.0	0.065	31W-0300X0250-1-6
31W-0400X0150-1-4	4 x 1.5	10.0	0.065	31W-0400X0150-1-6
31W-0400X0200-1-4	4 x 2	8.0	0.083	31W-0400X0200-1-6
31W-0400X0250-1-4	4 x 2.5	6.0	0.083	31W-0400X0250-1-6
31W-0400X0300-1-4	4 x 3	4.0	0.083	31W-0400X0300-1-6
31W-0600X0300-1-4	6 x 3	5.5	0.109	31W-0600X0300-1-6
31W-0600X0400-1-4	6 x 4	5.5	0.109	31W-0600X0400-1-6

32W

Buttweld Eccentric Reducer

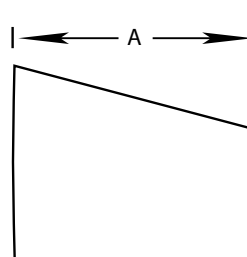

304 Item Number	Tube O.D.	A	Nominal Wall Thickness	316L Item Number
32W-0075X0050-1-4	.75 x.5	1.0	0.065	32W-0075X0050-1-6
32W-0100X0050-1-4	1 x.5	2.0	0.065	32W-0100X0050-1-6
32W-0100X0075-1-4	1 x.75	1.0	0.065	32W-0100X0075-1-6
32W-0150X0050-1-4	1.5 x.5	4.0	0.065	32W-0150X0050-1-6
32W-0150X0075-1-4	1.5 x.75	3.0	0.065	32W-0150X0075-1-6
32W-0150X0100-7-4	1.5 x 1	2.0	0.065	32W-0150X0100-1-6
32W-0200X0050-1-4	2 x.5	6.0	0.065	32W-0200X0050-1-6
32W-0200X0075-1-4	2 x.75	5.0	0.065	32W-0200X0075-1-6
32W-0200X0100-7-4	2 x 1	4.0	0.065	32W-0200X0100-1-6
32W-0200X0150-7-4	2 x 1.5	2.0	0.065	32W-0200X0150-1-6
32W-0250X0100-7-4	2.5 x 1	6.0	0.065	32W-0250X0100-1-6
32W-0250X0150-7-4	2.5 x 1.5	4.0	0.065	32W-0250X0150-1-6
32W-0250X0200-7-4	2.5 x 2	2.0	0.065	32W-0250X0200-1-6
32W-0300X0100-7-4	3 x 1	8.0	0.065	32W-0300X0100-1-6
32W-0300X0150-7-4	3 x 1.5	6.0	0.065	32W-0300X0150-1-6
32W-0300X0200-7-4	3 x 2	4.0	0.065	32W-0300X0200-1-6
32W-0300X0250-7-4	3 x 2.5	2.0	0.065	32W-0300X0250-1-6
32W-0400X0150-7-4	4 x 1.5	10.0	0.065	32W-0400X0150-1-6
32W-0400X0200-7-4	4 x 2	8.0	0.083	32W-0400X0200-1-6
32W-0400X0250-7-4	4 x 2.5	6.0	0.083	32W-0400X0250-1-6
32W-0400X0300-7-4	4 x 3	4.0	0.083	32W-0400X0300-1-6
32W-0600X0300-7-4	6 x 3	5.5	0.109	32W-0600X0300-1-6
32W-0600X0400-7-4	6 x 4	5.5	0.109	32W-0600X0400-1-6